

SPECIAL USE PERMIT APPLICATION

CITY OF PRAIRIE VILLAGE, KANSAS

For Office Use Only

Case No.: PC 2015-08
Filing Fees: \$100
Deposit: \$500



Date Advertised: 6/16/15
Date Notices Sent: 6/16/15
Public Hearing Date: 7/7/15

APPLICANT: MVS, LLC PHONE: 816-444-0900

ADDRESS: 7611 State Line Rd. Ste. 301, Kansas City, MO 64114 E-MAIL: RandyB@Tutera.com; rjones@nspjarch.com

OWNER: MVS, LLC PHONE: 816-444-0900

ADDRESS: 7611 State Line Rd. Ste. 301, Kansas City, MO ZIP: 64114

LOCATION OF PROPERTY: 8500 Mission Road

LEGAL DESCRIPTION: Block 1, Meadowbrook Junior High School

ADJACENT LAND USE AND ZONING:

	<u>Land Use</u>	<u>Zoning</u>
North	<u>Residential</u>	<u>R-3</u>
South	<u>Residential</u>	<u>R-1a</u>
East	<u>Residential</u>	<u>R-1a</u>
West	<u>Residential</u>	<u>R-1a and R-3</u>

Present Use of Property: Vacant Middle School Building

Please complete both pages of the form and return to:
Planning Commission Secretary
City of Prairie Village
7700 Mission Road
Prairie Village, KS 66208

Does the proposed special use meet the following standards? If yes, attach a separate Sheet explaining why.

	<u>Yes</u>	<u>No</u>
1. Is deemed necessary for the public convenience at that location.	<u>X</u>	<u> </u>
2. Is so designed, located and proposed to be operated that the public health, safety, and welfare will be protected.	<u>X</u>	<u> </u>
3. Is found to be generally compatible with the neighborhood in which it is proposed.	<u>X</u>	<u> </u>
4. Will comply with the height and area regulations of the district in which it is proposed.	<u>X</u>	<u> </u>
5. Off-street parking and loading areas will be provided in accordance with the standards set forth in the zoning regulations, and such areas will be screened from adjoining residential uses and located so as to protect such residential use from any injurious effect.	<u>X</u>	<u> </u>
6. Adequate utility, drainage, and other such necessary facilities have been or will be provided.	<u>X</u>	<u> </u>

Should this special use be valid only for a specific time period? Yes No X

If Yes, what length of time? Indefinite

SIGNATURE: 

DATE: 6/5/15

BY: Joseph Tutera

TITLE: Manager, MVS LLC

Attachments Required:

- Site plan showing existing and proposed structures on the property in questions, and adjacent property, off-street parking, driveways, and other information.
- Certified list of property owners

AFFIDAVIT

STATE OF KANSAS)
) SS:
COUNTY OF JOHNSON)

Amy L. Grant, being duly sworn upon her oath, being of sound mind and legal age deposes and states:

1. That she is an agent for the owner of the property described in the attached notice upon which an application for Special Use Permit has been filed before the City Planning Commission of the City of Prairie Village, Kansas.
2. On the 22nd day of June, 2015 a public information meeting was held pursuant to the Citizen Participation Policy adopted on June 6, 2000, by the Planning Commission.
3. That on the 16th day of June, 2015, I did comply with notification requirements to landowners as stated in K.S.A. 12-757(b) and Section 19.28.020, of the Prairie Village Zoning Regulations and notified in letter by certified mail, return receipt to all owners of land located within 200 feet of the described real property. Notice was mailed to the following: See attached Exhibit A.
4. In addition to the required notice referenced in item 3, and though not required by applicable law, courtesy notices were also sent to those addresses listed on Exhibit B.

Amy Grant
Name Amy Grant

Subscribed and sworn to before me this 23rd day of June, 2015.

Judith L. Hunt
Notary Public

My Commission Expires:



MVS, L.L.C.
7611 STATE LINE ROAD, SUITE 301
KANSAS CITY, MO 64114
(816) 444-0900

NOTICE TO PROPERTY OWNERS
PLANNING COMMISSION
PRAIRIE VILLAGE, KANSAS
June 16, 2015

Application No. PC 2015-08

An application for a Special Use Permit, as applied to the property located at 8500 Mission Road, has been filed by MVS, LLC and would authorize the operation of an Adult Senior Dwelling project including independent living and assisted living uses on 18.43 acres of property legally described as follows:

ALL OF BLOCK 1, EXCEPT THE EAST 12 FEET, THEREOF, MEADOWBROOK JUNIOR HIGH SCHOOL, A SUBDIVISION IN THE CITY OF PRAIRIE VILLAGE, JOHNSON COUNTY, KANSAS AND ALL OF VACATED ORIGINAL SOMERSET DRIVE ADJACENT THERETO, EXCEPT ANY PART USED OR DEDICATED FOR STREETS, ROADS OR PUBLIC RIGHTS OF WAY AND EXCEPT THE FOLLOWING DESCRIBED TRACTS OF LAND BEING MORE PARTICULARLY DESCRIBED AS FOLLOWS:

A PART OF THE SE¼ OF SECTION 28, TOWNSHIP 12, RANGE 25, JOHNSON COUNTY, KANSAS, MORE PARTICULARLY DESCRIBED AS FOLLOWS: BEGINNING AT A POINT ON THE NORTH LINE AND 1150 FEET WEST OF THE NORTHEAST CORNER OF THE SE¼ OF SAID SECTION 28; THENCE S 0° 17' 50" E, ALONG A LINE PARALLEL TO AND 180 FEET, EAST OF THE WEST LINE OF THE NE¼ OF THE SE¼ OF SAID SECTION 28, SAID LINE ALSO BEING THE CENTERLINE OF SOMERSET DRIVE, AS NOW LOCATED; A DISTANCE OF 996.83 FEET, TO A POINT OF CURVATURE; THENCE SOUTHERLY, ALONG A CURVE TO THE RIGHT HAVING A RADIUS OF 500 FEET, A DISTANCE OF 18.52 FEET; THENCE S 88° 10' 31" E, ALONG A RADIAL LINE, TO THE LAST DESCRIBED CURVE, A DISTANCE OF 40 FEET, TO A POINT ON THE EAST LINE OF SAID SOMERSET DRIVE, SAID POINT BEING THE POINT OF BEGINNING OF THE TRACT OF LAND TO BE DESCRIBED HEREIN; THENCE N 89° 42' 10" E, A DISTANCE OF 181.43 FEET, TO A POINT ON THE EAST LINE OF THE VACATED RIGHT-OF-WAY FOR SOMERSET DRIVE; THENCE SOUTHWESTERLY, ALONG THE EASTERLY RIGHT-OF-WAY OF SAID VACATED SOMERSET DRIVE, SAID LINE BEING ON A CURVE TO THE RIGHT HAVING A RADIUS OF 5770 FEET AND WHOSE INITIAL TANGENT BEARING IS S 40° 28' 19" W, A DISTANCE OF 310.29 FEET, TO A POINT ON THE SOUTHWESTERLY PROPERTY LINE OF THE MEADOWBROOK JUNIOR HIGH SCHOOL PROPERTY, AS NOW LOCATED, SAID LINE ALSO BEING THE NORTHEASTERLY LINE OF LOT 98, TOWN AND COUNTRY ESTATES, A SUBDIVISION OF LAND NOW IN THE CITY OF PRAIRIE VILLAGE, JOHNSON COUNTY, KANSAS; THENCE N 46° 25' 57" W, ALONG SAID PROPERTY LINES, A DISTANCE OF 31.31 FEET, TO A POINT ON THE EASTERLY RIGHT-OF-WAY LINE OF SOMERSET DRIVE AS NOW LOCATED; THENCE NORTHEASTERLY, ALONG THE EASTERLY RIGHT-OF-WAY LINE OF SAID SOMERSET DRIVE, SAID RIGHT-OF-WAY LINE BEING ON A CURVE TO THE LEFT HAVING A RADIUS OF 540 FEET AND WHOSE INITIAL TANGENT BEARING IS N 24° 38' 48" E, A DISTANCE OF 215.09 FEET, TO THE POINT OF BEGINNING.

AND EXCEPT:

ALL THAT PART OF THE EAST ½ OF THE EAST ½ OF SECTION 28, TOWNSHIP 12, RANGE 25, IN JOHNSON COUNTY, KANSAS, MORE PARTICULARLY DESCRIBED AS FOLLOWS: BEGINNING AT A POINT ON A LINE RADIAL TO THE CURVE OF SOMERSET DRIVE AS NOW ESTABLISHED, SAID RADIAL LINE PASSING THRU A POINT ON THE CENTERLINE OF SAID SOMERSET DRIVE, SAID POINT BEING 39.39 FEET NORTHEASTERLY OF THE WEST LINE OF THE EAST ½ OF THE EAST ½ OF SAID SECTION 28, MEASURED ALONG SAID CENTERLINE OF SOMERSET DRIVE; THENCE SOUTHEASTERLY ALONG SAID RADIAL LINE, A DISTANCE OF 40 FEET; THENCE NORTHEASTERLY ALONG A CURVE TO THE LEFT, TANGENT TO SAID CURVE BEING AT RIGHT ANGLES TO SAID RADIAL LINE, AND HAVING A RADIUS OF 540 FEET, A DISTANCE OF 192 FEET, MORE OR LESS, TO A POINT ON THE SOUTHWESTERLY LINE OF THE PLAT OF MEADOWBROOK JUNIOR HIGH SCHOOL, A SUBDIVISION OF LAND IN SAID COUNTY AS NOW ESTABLISHED; AND THE POINT OF BEGINNING OF THE TRACT TO BE HEREIN DESCRIBED; THENCE CONTINUING NORTHEASTERLY ALONG THE LAST DESCRIBED CURVE A DISTANCE OF 22 FEET, MORE OR LESS, TO A POINT ON THE NORTHWESTERLY LINE OF SAID PLAT; THENCE SOUTHWESTERLY ALONG SAID NORTHWESTERLY LINE A DISTANCE OF 21 FEET, MORE OR LESS, TO THE MOST WESTERLY CORNER OF SAID PLAT; THENCE SOUTHEASTERLY ALONG THE SOUTHWESTERLY LINE OF SAID PLAT A DISTANCE OF 9 FEET, MORE OR LESS, TO THE POINT OF BEGINNING.

AND ALSO EXCEPT:

ALL THAT PART OF THE SOUTHEAST ¼ OF SECTION 28, TOWNSHIP 12, RANGE 25, NOW IN THE CITY OF PRAIRIE VILLAGE, JOHNSON COUNTY, KANSAS, MORE PARTICULARLY DESCRIBED AS FOLLOWS: COMMENCING AT A POINT IN THE EAST-WEST CENTERLINE OF SAID SECTION 28, WHICH POINT IS 1150.00 FEET WEST OF THE EAST ¼ CORNER OF SAID SECTION 28, SAID POINT BEING THE INTERSECTION OF THE CENTERLINES OF 83RD STREET AND SOMERSET DRIVE AS NOW ESTABLISHED; THENCE SOUTH ALONG A LINE WHICH IS 180.00 FEET EAST OF AND PARALLEL TO THE WEST LINE OF THE NORTHEAST ¼ OF SAID SOUTHEAST ¼ SECTION (SAID LINE BEING THE CENTERLINE OF SAID SOMERSET DRIVE), A DISTANCE OF 996.83 FEET; THENCE EAST AT RIGHT ANGLES TO THE LAST DESCRIBED COURSE, A DISTANCE OF 40.00 FEET TO A POINT IN THE EASTERLY LINE OF SAID SOMERSET DRIVE; THENCE SOUTHERLY ALONG A CURVE TO THE RIGHT, TANGENT TO SAID CURVE BEING AT RIGHT ANGLES TO THE LAST DESCRIBED COURSE, HAVING A RADIUS OF 540.00 FEET, A DISTANCE OF 20.00 FEET; THENCE EASTERLY ALONG A LINE WHICH DEFLECTS TO THE LEFT 92° 07' 19" FROM THE TANGENT TO THE LAST DESCRIBED CURVE, A DISTANCE OF 128.47 FEET TO THE POINT OF BEGINNING OF THE TRACT OF LAND TO BE DESCRIBED HEREIN; THENCE CONTINUING EASTERLY ALONG THE LAST DESCRIBED COURSE A DISTANCE OF 52.96 FEET; THENCE NORTHEASTERLY ALONG A CURVE TO THE LEFT, TANGENT TO SAID CURVE DEFLECTING TO THE LEFT 49° 13' 50" FROM THE LAST DESCRIBED COURSE, A DISTANCE OF 376.72 FEET; THENCE NORTHWESTERLY ALONG A LINE AT RIGHT ANGLES TO THE TANGENT TO THE LAST DESCRIBED CURVE, A DISTANCE OF 40.00 FEET TO A POINT ON THE CENTERLINE OF VACATED SOMERSET DRIVE; THENCE SOUTHWESTERLY ALONG A CURVE TO THE RIGHT, TANGENT TO SAID CURVE BEING AT RIGHT ANGLES TO THE LAST DESCRIBED COURSE, HAVING A RADIUS OF 5730.00 FEET, A DISTANCE OF 408.69 FEET TO THE POINT OF BEGINNING.

The property is located in an R-1a Zoning District.

A public hearing will be held by the Planning Commission on Tuesday, July 7, 2015 at 7:00 p.m. in the City Council Chambers of City Hall, 7700 Mission Road, Prairie Village, Kansas, at which time you may appear, if you so desire, either in person and/or by attorney.

The hearing of this application is not limited to those receiving copies of this notice, and if you know of any neighbor or affected property owner who, for any reason, has failed to receive a copy, it would be appreciated if you would inform them of this public hearing. Any interested property owners are invited to attend. Copies of the proposed plan and complete legal description are available for public inspection at the Office of the Secretary of the Planning Commission at the Municipal Building located at 7700 Mission Road, Prairie Village, Kansas. At the time of the scheduled public hearing persons interested may be present, or may submit their comments in writing to the Planning Commission prior to the date of the scheduled hearing.

Signed: Randall Bloom
Randall Bloom, MVS, LLC

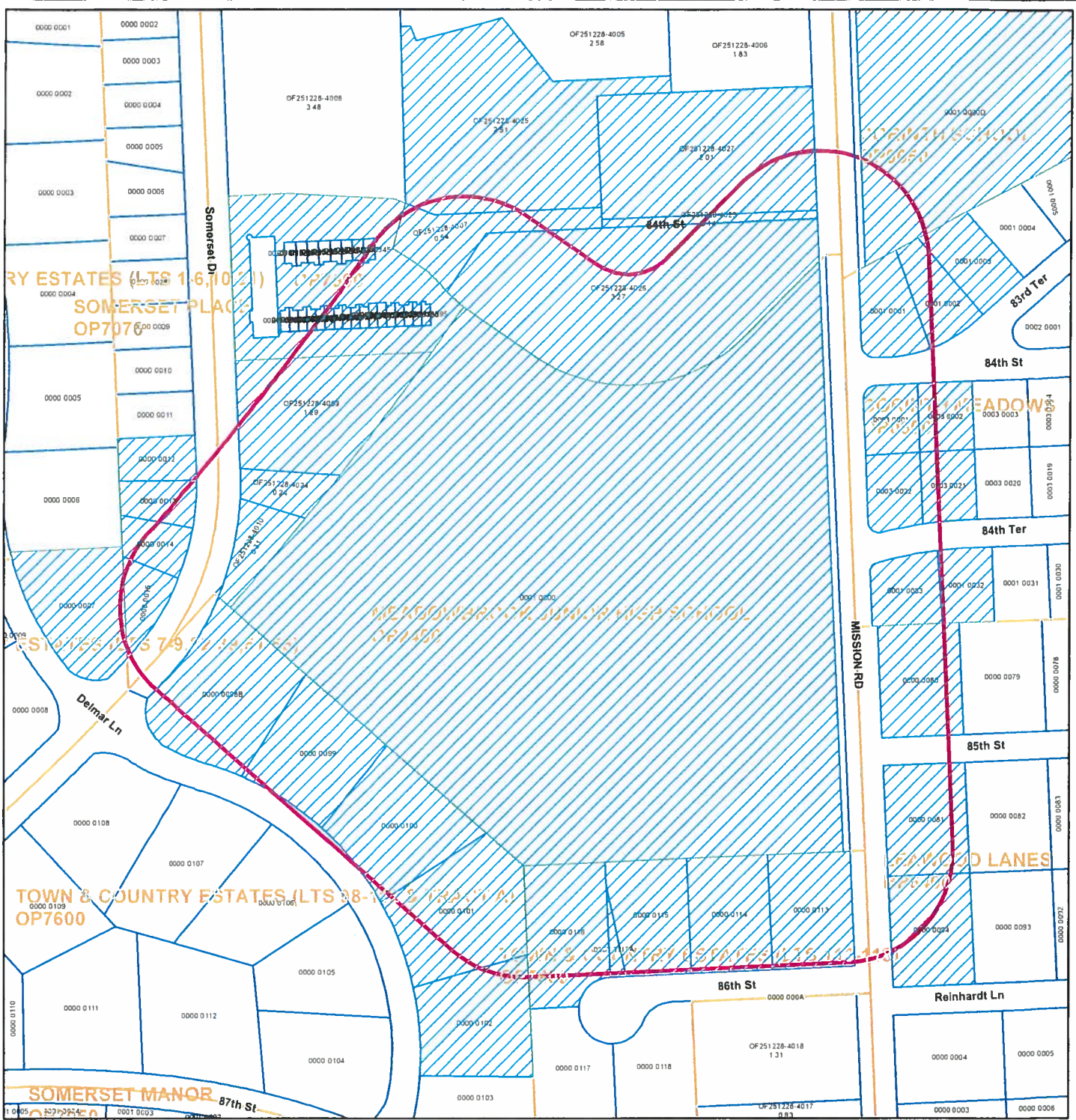

- Lot Line
- Section Line
- Plat Penmeter



200 ft Buffer Map

PARCELS WITHIN 200 FEET OF PARCEL OP24000001 0000
Produced June 09, 2015 at 03:18:36 PM

Parcel 1 of 95:

HP64000000 0081 (3609 W 85TH ST)
(OWNER[S] NAME/ADDRESS)
KERR, MATTHEW L.
KERR, CATHERINE C.
3609 W 85TH ST
LEAWOOD, KS 66206

Parcel 2 of 95:

HP64000000 0094 (8628 REINHARDT LN)
(OWNER[S] NAME/ADDRESS)
LARSON, JOHN E.
LARSON, CAROLYN K.
8628 REINHARDT LN
LEAWOOD, KS 66206

Parcel 3 of 95:

OF251228-4024 (8449 SOMERSET DR)
(OWNER[S] NAME/ADDRESS)
WILT, WILLIAM AND
WILT, VICKI LIVING TRUST
8449 SOMERSET DR
PRAIRIE VILLAGE, KS 66207

Parcel 4 of 95:

OF251228-4025 (8300 MISSION RD)
(OWNER[S] NAME/ADDRESS)
GRI CORINTH SOUTH LLC
4350 EAST-WEST HWY APT 400
BETHESDA, MD 20814
(BILLING NAME/ADDRESS)
FIRST WASHINGTON REALTY INC
4350 EAST-WEST HWY APT 400
BETHESDA, MD 20814

Parcel 5 of 95:

OF251228-4026 (3917 W 84TH ST)
(OWNER[S] NAME/ADDRESS)
PRAIRIE PROPERTY LL, LLC
1628 JFK BLVD APT 1600
PHILADELPHIA, PA 19103

Parcel 6 of 95:

OF251228-4009 (8401 SOMERSET DR)
(OWNER[S] NAME/ADDRESS)
SOMERSET APARTMENTS, L.L.C.
411 NICHOLS RD APT 245
KANSAS CITY, MO 64112

Parcel 7 of 95:

OP06000001 0003 (3800 W 83RD TER)
(OWNER[S] NAME/ADDRESS)
LUDWIG, EDSON
LUDWIG, LEONICE
3800 W 83RD TER
PRAIRIE VILLAGE, KS 66206

Parcel 8 of 95:

OP06500001 0000D (8301 MISSION RD)
(OWNER[S] NAME/ADDRESS)
CORINTH SCHOOL 32
TRUSTEES
7235 ANTIOCH RD
OVERLAND PARK, KS 66204
(BILLING NAME/ADDRESS)
CORINTH ELEM #111
UNIFIED SCHOOL DIST #512
7235 ANTIOCH RD
OVERLAND PARK, KS 66204

Parcel 9 of 95:

OP06000001 0032 (3807 W 84TH TER)
(OWNER[S] NAME/ADDRESS)
MICK, MARTHA
3807 W 84TH TER
PRAIRIE VILLAGE, KS 66206

Parcel 10 of 95:

OP06000003 0001 (8401 MISSION RD)
(OWNER[S] NAME/ADDRESS)
LAING, HELEN M. TRUSTEE
LAING-NESSLEIN, SUSAN TRUSTEE
8712 CATALINA ST
PRAIRIE VILLAGE, KS 66207

Parcel 11 of 95:

OF251228-4010 (8451 SOMERSET DR)
(OWNER[S] NAME/ADDRESS)
WILT, WILLIAM AND
WILT, VICKI LIVING TRUST
8449 SOMERSET DR
PRAIRIE VILLAGE, KS 66207

Parcel 12 of 95:

OP06000001 0002 (3808 W 83RD TER)
(OWNER[S] NAME/ADDRESS)
PEATTIE, LINDSAY
PEATTIE, SETH
3808 W 83RD TER
PRAIRIE VILLAGE, KS 66206

Parcel 13 of 95:

OP06000003 0021 (3808 W 84TH TER)
(OWNER[S] NAME/ADDRESS)
LIDDLE, CASEY
LIDDLE, MELISSA
3808 W 84TH TER
PRAIRIE VILLAGE, KS 66206

Parcel 14 of 95:
OP06000003 0022 (8415 MISSION RD)
(OWNER[S] NAME/ADDRESS)
DIEGO, CECILIA
5111 GEMSBUCK CHASE
SAN ANTONIO, TX 78257

Parcel 15 of 95:
OP06000001 0033 (3815 W 84TH TER)
(OWNER[S] NAME/ADDRESS)
HARRIS, R. LEE
HARRIS, BARBARA A.
3815 W 84TH TER
PRAIRIE VILLAGE, KS 66206

Parcel 16 of 95:
OP06000003 0002 (3809 W 84TH ST)
(OWNER[S] NAME/ADDRESS)
CAROLAN, WILLIAM
3809 W 84TH ST
PRAIRIE VILLAGE, KS 66206

Parcel 17 of 95:
OP06000001 0001 (8335 MISSION RD)
(OWNER[S] NAME/ADDRESS)
BARATTA, MARC L.
8335 MISSION RD
PRAIRIE VILLAGE, KS 66206

Parcel 18 of 95:
OP24000001 0000 (8500 MISSION RD)
(OWNER[S] NAME/ADDRESS)
MVS, LLC
7611 STATE LINE RD APT 301
KANSAS CITY, MO 64114
(BILLING NAME/ADDRESS)
BIRK, SCOTT
7611 STATE LINE RD APT 301
KANSAS CITY, MO 64114

Parcel 19 of 95:
OP750000BN U8347 (8347 SOMERSET DR)
(OWNER[S] NAME/ADDRESS)
HUNT, JOAN S. TRUSTEE
HUNT, JOAN S. TRUST
8347 SOMERSET DR

PRAIRIE VILLAGE, KS 66207

Parcel 20 of 95:

OP70700000 0015 (8444 SOMERSET DR)
(OWNER[S] NAME/ADDRESS)
WOOD, FRANK J. JR REV TRUST
8444 SOMERSET DR
PRAIRIE VILLAGE, KS 66207

Parcel 21 of 95:

OP70700000 0012 (8420 SOMERSET DR)
(OWNER[S] NAME/ADDRESS)
BUSH, ANN HARTLEY TRUSTEE
BUSH, ANN HARTLEY REV TRUST
8420 SOMERSET DR
PRAIRIE VILLAGE, KS 66207

Parcel 22 of 95:

OP70700000 0014 (8436 SOMERSET DR)
(OWNER[S] NAME/ADDRESS)
ALEXANDER, BILL J.
ALEXANDER, VIRGINIA H.
8436 SOMERSET DR
PRAIRIE VILLAGE, KS 66207

Parcel 23 of 95:

OP76000000 0098B (8501 DELMAR LN)
(OWNER[S] NAME/ADDRESS)
LARSON BUILDING COMPANY
8416 ENSLEY LN
LEAWOOD, KS 66206

Parcel 24 of 95:

OP750000BN U8345 (8345 SOMERSET DR)
(OWNER[S] NAME/ADDRESS)
BARTON, CATHERINE K. TRUSTEE
BARTON, CATHERINE K. TRUST
8345 SOMERSET DR
PRAIRIE VILLAGE, KS 66207

Parcel 25 of 95:

OP750000BS U8379 (8379 SOMERSET DR)
(OWNER[S] NAME/ADDRESS)
WOHLGEMUTH, MATTHEW R.
8379 SOMERSET DR
PRAIRIE VILLAGE, KS 66207

Parcel 26 of 95:

OP750000BS U8383 (8383 SOMERSET DR)
(OWNER[S] NAME/ADDRESS)
MOELLER, SUSAN B.
8383 SOMERSET DR
PRAIRIE VILLAGE, KS 66207

Parcel 27 of 95:
OP750000BS U8391 (8391 SOMERSET DR)
(OWNER[S] NAME/ADDRESS)
VANDERPOOL, CANDICE L.
13304 A HIGHWAY
LIBERTY, KS 64068

Parcel 28 of 95:
OP750000BS U8393 (8393 SOMERSET DR)
(OWNER[S] NAME/ADDRESS)
DALBERG, GUDRUN B.
8393 SOMERSET DR
PRAIRIE VILLAGE, KS 66207

Parcel 29 of 95:
OP76000000 0007 (8417 DELMAR LN)
(OWNER[S] NAME/ADDRESS)
HANCOCK, WILLIAM R.
HANCOCK, NICKOLA K.
8417 DELMAR LN
PRAIRIE VILLAGE, KS 66207

Parcel 30 of 95:
OP76000000 0100 (8521 DELMAR LN)
(OWNER[S] NAME/ADDRESS)
GALLOWAY, LEWIS M
GALLOWAY, JAMIE D
8521 DELMAR LN
PRAIRIE VILLAGE, KS 66207

Parcel 31 of 95:
OP750000BS U8385 (8385 SOMERSET DR)
(OWNER[S] NAME/ADDRESS)
PETROWSKI, JOHN D.
PETROWSKI, JANET L.
8125 ROSEHILL RD
LENEXA, KS 66215

Parcel 32 of 95:
OP750000BS U8395 (8395 SOMERSET DR)
(OWNER[S] NAME/ADDRESS)
MARINE, HAROLD C. TRUSTEE
MARINE, THERESA TRUSTEE
8395 SOMERSET DR
PRAIRIE VILLAGE, KS 66207

Parcel 33 of 95:
OP750000BW U301 (8361 SOMERSET DR APT 301)
(OWNER[S] NAME/ADDRESS)
HICKLIN, MARCIA REV TRUST
3401 GROVE GATE CT APT 1635
RICHMOND, VA 23233

Parcel 34 of 95:

OP750000BW U302 (8361 SOMERSET DR APT 302)
(OWNER[S] NAME/ADDRESS)
RICHARD, ROBERT STEVEN
8361 SOMERSET DR APT 302
PRAIRIE VILLAGE, KS 66207

Parcel 35 of 95:
OP750000BW U303 (8361 SOMERSET DR APT 303)
(OWNER[S] NAME/ADDRESS)
WILLIAMS, NORMAN S.
8361 SOMERSET DR APT 303
PRAIRIE VILLAGE, KS 66207

Parcel 36 of 95:
OP750000BW U304 (8361 SOMERSET DR APT 304)
(OWNER[S] NAME/ADDRESS)
FLEMINGTON, CLARE S.
8361 SOMERSET DR APT 304
PRAIRIE VILLAGE, KS 66207

Parcel 37 of 95:
OP750000BW U305 (8361 SOMERSET DR APT 305)
(OWNER[S] NAME/ADDRESS)
MARSH, RANDOLPH S.
8361 SOMERSET DR APT 305
PRAIRIE VILLAGE, KS 66207

Parcel 38 of 95:
OP750000BW U201 (8361 SOMERSET DR APT 201)
(OWNER[S] NAME/ADDRESS)
COON, DANIEL J. TRUST
8101 FONTANA ST
PRAIRIE VILLAGE, KS 66208

Parcel 39 of 95:
OP750000BW U202 (8361 SOMERSET DR APT 202)
(OWNER[S] NAME/ADDRESS)
MURPHY, WAYNE T.
219 PINE RD
SEWICKLEY, PA 15143

Parcel 40 of 95:
OP750000BW U203 (8361 SOMERSET DR APT 203)
(OWNER[S] NAME/ADDRESS)
SHORMAN, GARY D
SHORMAN, MARY ANN
3005 THUNDERBIRD DR
HAYS, KS 67601

Parcel 41 of 95:
OP750000BW U204 (8361 SOMERSET DR APT 204)
(OWNER[S] NAME/ADDRESS)
COON, MARGARET M. REV TRUST
8101 FONTANA ST

PRAIRIE VILLAGE, KS 66208

Parcel 42 of 95:

OP750000BW U205 (8361 SOMERSET DR APT 205)

(OWNER[S] NAME/ADDRESS)

CURTIS, NANCY L. TRUSTEE
CURTIS, CHARLES L. TRUSTEE
2905 COTTON WOOD LN
HAYS, KS 67601

Parcel 43 of 95:

OP750000BW U300 (8361 SOMERSET DR APT 300)

(OWNER[S] NAME/ADDRESS)

THEIN, STACEY M
THEIN, DAVID J
8361 SOMERSET DR APT 300
PRAIRIE VILLAGE, KS 66207

Parcel 44 of 95:

OP750000BW 00U1 (8361 SOMERSET DR APT 1)

(OWNER[S] NAME/ADDRESS)

CHATEAU HOME OWNERS
ASSOCIATION
8361 SOMERSET DR APT 101
PRAIRIE VILLAGE, KS 66207
(BILLING NAME/ADDRESS)
CURRY ASSOC MANAGEMENT, INC.
2700 KENDALLWOOD PKWY
KANSAS CITY, MO 64119

Parcel 45 of 95:

OP750000BW U101 (8361 SOMERSET DR APT 101)

(OWNER[S] NAME/ADDRESS)

BEVAN, BARBARA C. TRUSTEE
BEVAN FAMILY TRUST
8361 SOMERSET DR APT 101
PRAIRIE VILLAGE, KS 66207

Parcel 46 of 95:

OP750000BW U102 (8361 SOMERSET DR APT 102)

(OWNER[S] NAME/ADDRESS)

MARTIN, KEVIN W.
8361 SOMERSET DR APT 102
PRAIRIE VILLAGE, KS 66207

Parcel 47 of 95:

OP750000BW U103 (8361 SOMERSET DR APT 103)

(OWNER[S] NAME/ADDRESS)

DEETS, FRANCES P.
PENCE, EARL R.
8361 SOMERSET DR APT 103
PRAIRIE VILLAGE, KS 66207

Parcel 48 of 95:
OP750000BW U104 (8361 SOMERSET DR APT 104)
(OWNER[S] NAME/ADDRESS)
CULLEN, STEPHEN A.
CULLEN-REESE, PEGGY A.
8361 SOMERSET DR APT 104
PRAIRIE VILLAGE, KS 66207

Parcel 49 of 95:
OP750000BW U105 (8361 SOMERSET DR APT 105)
(OWNER[S] NAME/ADDRESS)
NIDIFFER, T J
8361 SOMERSET DR APT 105
PRAIRIE VILLAGE, KS 66207

Parcel 50 of 95:
OP750000BS U8385 (8385 SOMERSET DR)
(OWNER[S] NAME/ADDRESS)
PETROWSKI, JOHN D.
PETROWSKI, JANET L.
8125 ROSEHILL RD
LENEXA, KS 66215

Parcel 51 of 95:
OP750000BS U8387 (8387 SOMERSET DR)
(OWNER[S] NAME/ADDRESS)
SCHNIEDERS, JOHN H TRUST
PO BOX 428
OTTAWA, KS 66067

Parcel 52 of 95:
OP750000BS U8389 (8389 SOMERSET DR)
(OWNER[S] NAME/ADDRESS)
RHUDY, DIMITRA
8389 SOMERSET DR
PRAIRIE VILLAGE, KS 66207

Parcel 53 of 95:
OP750000BS U8391 (8391 SOMERSET DR)
(OWNER[S] NAME/ADDRESS)
VANDERPOOL, CANDICE L.
13304 A HIGHWAY
LIBERTY, KS 64068

Parcel 54 of 95:
OP750000BS U8393 (8393 SOMERSET DR)
(OWNER[S] NAME/ADDRESS)
DALBERG, GUDRUN B.
8393 SOMERSET DR
PRAIRIE VILLAGE, KS 66207

Parcel 55 of 95:
OP750000BS U8395 (8395 SOMERSET DR)
(OWNER[S] NAME/ADDRESS)

MARINE, HAROLD C. TRUSTEE
MARINE, THERESA TRUSTEE
8395 SOMERSET DR
PRAIRIE VILLAGE, KS 66207

Parcel 56 of 95:

OP750000BS U8373 (8373 SOMERSET DR)
(OWNER[S] NAME/ADDRESS)
RAINEY, FRANCES L. TRUST
8373 SOMERSET DR
PRAIRIE VILLAGE, KS 66207

Parcel 57 of 95:

OP750000BS U8375 (8375 SOMERSET DR)
(OWNER[S] NAME/ADDRESS)
VALENTINE, FRED J. TRUSTEE
VALENTINE, FRED J. TRUST
8375 SOMERSET DR
PRAIRIE VILLAGE, KS 66207

Parcel 58 of 95:

OP750000BS U8377 (8377 SOMERSET DR)
(OWNER[S] NAME/ADDRESS)
ANDERSON, JACLYN
8377 SOMERSET DR
PRAIRIE VILLAGE, KS 66207

Parcel 59 of 95:

OP750000BS U8379 (8379 SOMERSET DR)
(OWNER[S] NAME/ADDRESS)
WOHLGEMUTH, MATTHEW R.
8379 SOMERSET DR
PRAIRIE VILLAGE, KS 66207

Parcel 60 of 95:

OP750000BS U8381 (8381 SOMERSET DR)
(OWNER[S] NAME/ADDRESS)
WOOSLEY, HOWARD R. TRUSTEE
WOOSLEY, MARY GAY TRUSTEE
2403 W 69TH TER
MISSION HILLS, KS 66208

Parcel 61 of 95:

OP750000BS U8383 (8383 SOMERSET DR)
(OWNER[S] NAME/ADDRESS)
MOELLER, SUSAN B.
8383 SOMERSET DR
PRAIRIE VILLAGE, KS 66207

Parcel 62 of 95:

OP750000BN U8359 (8359 SOMERSET DR)
(OWNER[S] NAME/ADDRESS)
BARLOW, MAX MILTON
8359 SOMERSET DR

PRAIRIE VILLAGE, KS 66207

Parcel 63 of 95:

OP750000BS U8363 (8363 SOMERSET DR)
(OWNER[S] NAME/ADDRESS)
HARRIS, SUZANNE L.
8363 SOMERSET DR
PRAIRIE VILLAGE, KS 66207

Parcel 64 of 95:

OP750000BS U8365 (8365 SOMERSET DR)
(OWNER[S] NAME/ADDRESS)
MCGRATH, MATTHEW B.
8365 SOMERSET DR
PRAIRIE VILLAGE, KS 66207

Parcel 65 of 95:

OP750000BS U8367 (8367 SOMERSET DR)
(OWNER[S] NAME/ADDRESS)
CHRISTOPHER CONSTRUCTION, LLC
5238 W 98TH TER
OVERLAND PARK, KS 66207

Parcel 66 of 95:

OP750000BS U8369 (8369 SOMERSET DR)
(OWNER[S] NAME/ADDRESS)
THOMAS, KATHLEEN A
8369 SOMERSET DR
PRAIRIE VILLAGE, KS 66207

Parcel 67 of 95:

OP750000BS U8371 (8371 SOMERSET DR)
(OWNER[S] NAME/ADDRESS)
DEXTER, GEORGE A.
DEXTER, BRUCE P. JR
8371 SOMERSET DR
PRAIRIE VILLAGE, KS 66207

Parcel 68 of 95:

OP750000BN U8347 (8347 SOMERSET DR)
(OWNER[S] NAME/ADDRESS)
HUNT, JOAN S. TRUSTEE
HUNT, JOAN S. TRUST
8347 SOMERSET DR
PRAIRIE VILLAGE, KS 66207

Parcel 69 of 95:

OP750000BN U8349 (8349 SOMERSET DR)
(OWNER[S] NAME/ADDRESS)
FERAZZI, PATRICIA
8349 SOMERSET DR
PRAIRIE VILLAGE, KS 66207

Parcel 70 of 95:

OP750000BN U8351 (8351 SOMERSET DR)
(OWNER[S] NAME/ADDRESS)
ANDERSON, C. ANN
8351 SOMERSET DR
PRAIRIE VILLAGE, KS 66207

Parcel 71 of 95:
OP750000BN U8353 (8353 SOMERSET DR)
(OWNER[S] NAME/ADDRESS)
NESSELRODE, MARY WALLER TTEE
NESSELRODE, MARY WALLER TRUST
8353 SOMERSET DR
PRAIRIE VILLAGE, KS 66207

Parcel 72 of 95:
OP750000BN U8355 (8355 SOMERSET DR)
(OWNER[S] NAME/ADDRESS)
FOLEY, STEPHEN
LEPINE, LORRAINE
8355 SOMERSET DR
PRAIRIE VILLAGE, KS 66207

Parcel 73 of 95:
OP750000BN U8357 (8357 SOMERSET DR)
(OWNER[S] NAME/ADDRESS)
JACKSON, WILLIAM DAVID
JACKSON, LAURA
PO BOX 29
ARROW ROCK, MO 65320

Parcel 74 of 95:
OP750000BN U8345 (8345 SOMERSET DR)
(OWNER[S] NAME/ADDRESS)
BARTON, CATHERINE K. TRUSTEE
BARTON, CATHERINE K. TRUST
8345 SOMERSET DR
PRAIRIE VILLAGE, KS 66207

Parcel 75 of 95:
OP750000BS U8375 (8375 SOMERSET DR)
(OWNER[S] NAME/ADDRESS)
VALENTINE, FRED J. TRUSTEE
VALENTINE, FRED J. TRUST
8375 SOMERSET DR
PRAIRIE VILLAGE, KS 66207

Parcel 76 of 95:
OP750000BS U8387 (8387 SOMERSET DR)
(OWNER[S] NAME/ADDRESS)
SCHNIEDERS, JOHN H TRUST
PO BOX 428
OTTAWA, KS 66067

Parcel 77 of 95:

OP76000000 0115 (4000 W 86TH ST)
(OWNER[S] NAME/ADDRESS)
DOERR, BRIAN D.
DOERR, CYNTHIA E.
4000 W 86TH ST
PRAIRIE VILLAGE, KS 66207

Parcel 78 of 95:
OP76000000 0115A (0 NS NT)
(OWNER[S] NAME/ADDRESS)
KERR, WHITNEY E. JR
KERR, DEBORAH R.
4020 W 86TH ST
PRAIRIE VILLAGE, KS 66207

Parcel 79 of 95:
OP750000BS U8369 (8369 SOMERSET DR)
(OWNER[S] NAME/ADDRESS)
THOMAS, KATHLEEN A
8369 SOMERSET DR
PRAIRIE VILLAGE, KS 66207

Parcel 80 of 95:
OP750000BS U8371 (8371 SOMERSET DR)
(OWNER[S] NAME/ADDRESS)
DEXTER, GEORGE A.
DEXTER, BRUCE P. JR
8371 SOMERSET DR
PRAIRIE VILLAGE, KS 66207

Parcel 81 of 95:
OP750000BS U8373 (8373 SOMERSET DR)
(OWNER[S] NAME/ADDRESS)
RAINEY, FRANCES L. TRUST
8373 SOMERSET DR
PRAIRIE VILLAGE, KS 66207

Parcel 82 of 95:
OP70700000 0013 (8428 SOMERSET DR)
(OWNER[S] NAME/ADDRESS)
ELY, MARY JO LIV TRUST
CAISLEY, SUSAN E
8428 SOMERSET DR
PRAIRIE VILLAGE, KS 66207

Parcel 83 of 95:
OP750000BS U8381 (8381 SOMERSET DR)
(OWNER[S] NAME/ADDRESS)
WOOSLEY, HOWARD R. TRUSTEE
WOOSLEY, MARY GAY TRUSTEE
2403 W 69TH TER
MISSION HILLS, KS 66208

Parcel 84 of 95:

OP76000000 0099 (8511 DELMAR LN)
(OWNER[S] NAME/ADDRESS)
FRISCH, BENJAMIN J.
FRISCH, STACEY L.
8511 DELMAR LN
PRAIRIE VILLAGE, KS 66207

Parcel 85 of 95:
OP76000000 0101 (8601 DELMAR LN)
(OWNER[S] NAME/ADDRESS)
LEVENS, ESTHER H TRUST
8601 DELMAR LN
PRAIRIE VILLAGE, KS 66207

Parcel 86 of 95:
OP76000000 0116 (4020 W 86TH ST)
(OWNER[S] NAME/ADDRESS)
KERR, WHITNEY E. JR
KERR, DEBORAH R.
4020 W 86TH ST
PRAIRIE VILLAGE, KS 66207

Parcel 87 of 95:
OP750000BS U8377 (8377 SOMERSET DR)
(OWNER[S] NAME/ADDRESS)
ANDERSON, JACLYN
8377 SOMERSET DR
PRAIRIE VILLAGE, KS 66207

Parcel 88 of 95:
OP750000BS U8389 (8389 SOMERSET DR)
(OWNER[S] NAME/ADDRESS)
RHUDY, DIMITRA
8389 SOMERSET DR
PRAIRIE VILLAGE, KS 66207

Parcel 89 of 95:
OP76000000 0102 (8611 DELMAR LN)
(OWNER[S] NAME/ADDRESS)
SCHMIDT, MICHELLE A.
SCHMIDT, JARRET B.
8611 DELMAR LN
PRAIRIE VILLAGE, KS 66207

Parcel 90 of 95:
OP76000000 0114 (3920 W 86TH ST)
(OWNER[S] NAME/ADDRESS)
STANDARD INVESTMENTS LLC
11233 NALL AVE APT 130
LEAWOOD, KS 66211

Parcel 91 of 95:
HP64000000 0080 (3608 W 85TH ST)
(OWNER[S] NAME/ADDRESS)

GRIMM, JAN T.
3608 W 85TH ST
LEAWOOD, KS 66206

Parcel 92 of 95:
OP76000000 0113 (3900 W 86TH ST)
(OWNER[S] NAME/ADDRESS)
MARSH, GARY W.
MARSH, DEANNA L.
3900 W 86TH ST
PRAIRIE VILLAGE, KS 66207

Parcel 93 of 95:
OF251228-4027 (8340 MISSION RD)
(OWNER[S] NAME/ADDRESS)
TOWER PROPERTIES COMPANY
1000 WALNUT ST APT 900
KANSAS CITY, MO 64106

Parcel 94 of 95:
OF251228-4023 (0 NS NT)
(OWNER[S] NAME/ADDRESS)
TOWER PROPERTIES COMPANY
1000 WALNUT ST APT 900
KANSAS CITY, MO 64106

Parcel 95 of 95:
OF251228-4007 (0 NS NT)
(OWNER[S] NAME/ADDRESS)
CORINTH GARDENS ADJACENT, LLC
1628 JFK BLVD APT 1600
PHILADELPHIA, PA 19103
(BILLING NAME/ADDRESS)
GOLDOLLER REAL ESTATE INV. LLC
8 PENN CENTER
1628 JFK BLVD APT 1600
PHILADELPHIA, PA 19103

EXHIBIT B

Mission Chateau 072868-449966 200 Foot Notice, except public streets and ways (Created 06/16/2015)
HP64000000 0093
ELDRED, MICHAEL E. ELDRED, JENNIFER L. 8624 REINHARDT LN LEAWOOD, KS 66206
HP76000000 0106
MILLER, RITA ANN TRUST 8520 DELMAR LN PRAIRIE VILLAGE, KS 66207
HP76000000 0107
CLOUGH, THOMAS D CLOUGH, JOAN 8510 DELMAR LN PRAIRIE VILLAGE, KS 66207
HP76000000 0006
BRZON, GEORGE A BRZON, UNA M. 8401 DELMAR LN PRAIRIE VILLAGE, KS 66207
OP70700000 0011
Thomas M. Johnston Rhetta Johnston 8412 Somerset Drive Prairie Village, KS 66207
OP06000001 0004
Steven W. McKelvey 3716 W. 83 rd Terrace Prairie Village, KS 66206
OP06000003 0003
Diana K. Lebow 3801 W. 84 th Street Prairie Village, KS 66206
OP06000003 0020
Dale Foster Esther Foster 3800 W. 84 th Terrace Prairie Village, KS 66206
OP06000001 0031
Mann Grantor Trust 3801 W. 84 th Terrace Prairie Village, KS 66206

HP64000000 0079

Myers Family Living Trust
3604 W. 85th Street
Prairie Village, KS 66206

HP64000000 0082

Cameron B. Jones Co-Trustee
Deborah L. Jones Co-Trustee
3605 W. 85th Street
Leawood, KS 66206